

DENON®

DCD-1700NE

Super Audio CD Player

Quick start guide

Before you begin

What's in the box

Quick start guide



Safety Instructions



Cautions on Using Batteries



CD player

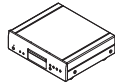

Power cord

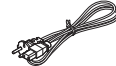

Remote control (RC-1249)

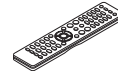

2×R03/AAA batteries



Audio cable



Required for setup

Amplifier

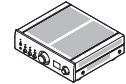

Speakers



Speaker cables



Setup

1

Connect DCD-1700NE to the amplifier

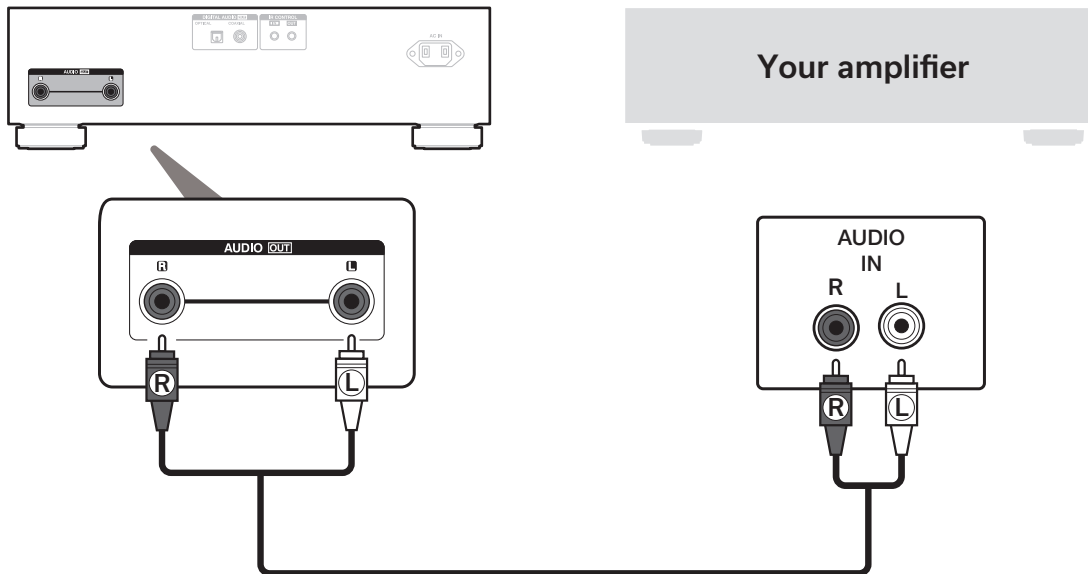

2

Connect to power

Connect the power cord between the DCD-1700NE and a wall outlet.

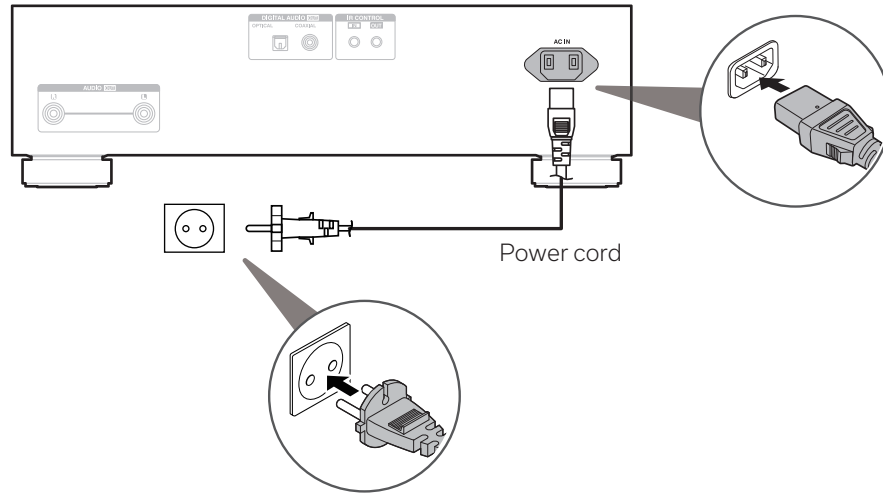

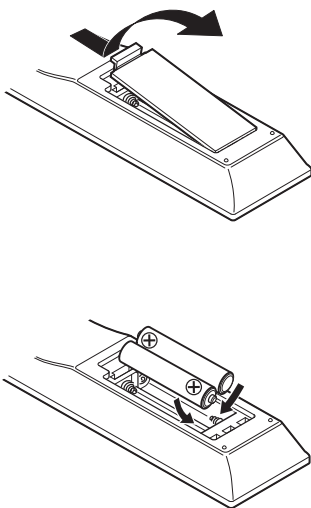
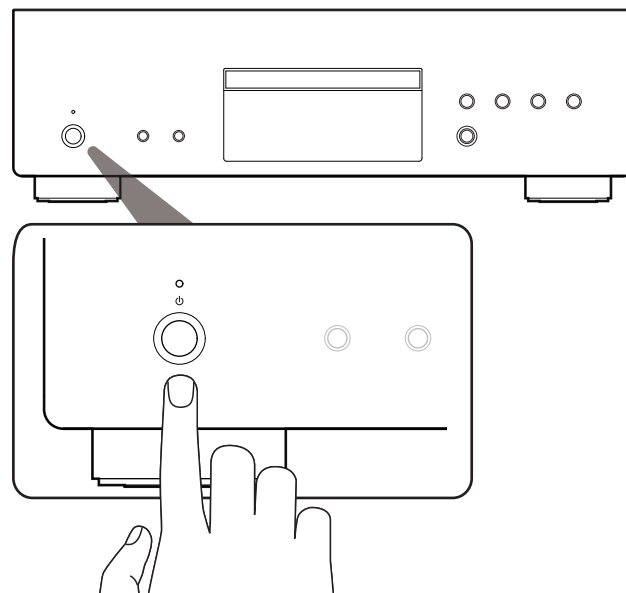
3**Install batteries in the remote control****4****Turn the DCD-1700NE's power on**

- Batteries can be taken out in reversed order.

5

Begin CD or Super Audio CD playback

- 1 Press ▲ to open the disc tray.

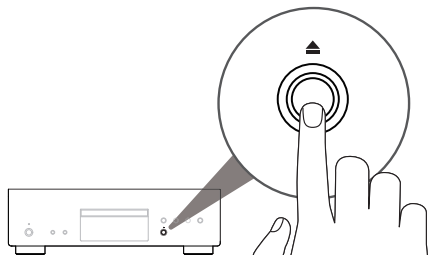

- 2 Place CD in the disc tray.

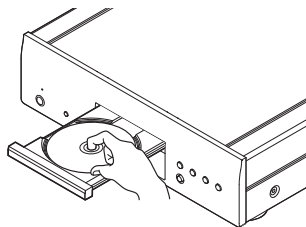

- 3 Press REMOTE MODE CD.
Switch the remote control operating mode to this unit.

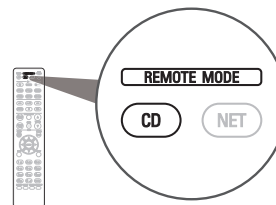

- 4 Press ▶/|| .
Playback starts.

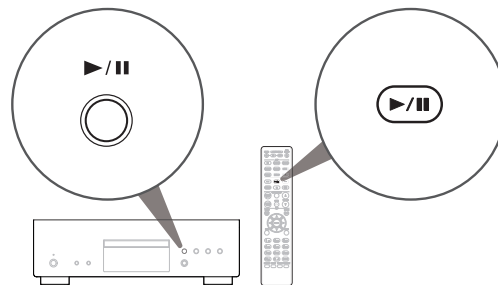

Owner's manual

Refer to the online manual for other functions information and operation procedure details.

manuals.denon.com/DCD1700NE/EU/EN/



Online manual

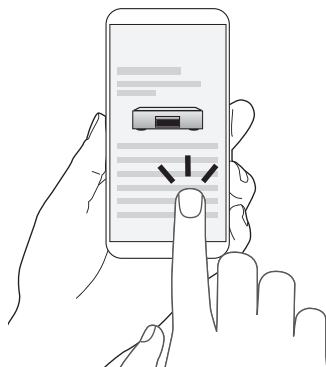

For more information, visit **www.denon.com**

DENON®

www.denon.com

Printed in Japan 5411 12029 00AD
© 2022 Sound United. All Rights Reserved.