

# DENON®

## DHT-S217

**Dolby Atmos Sound Bar**

# Quick Start Guide

Kurzanleitung / Guide de démarrage rapide / Guida di Avvio Rapido /  
Guía de inicio rápido / Snelhandleiding / Snabbstartsguide /  
Краткое руководство пользователя / Skrócona instrukcja obsługi

## Read Me First....

Bitte zuerst lesen... / Lisez-moi en premier.... / Nota preliminare.... /  
Lea esto primero.... / Lees mij eerst... / Läs detta först... /  
Прочитайте в первую очередь... / Przeczytaj to najpierw....

# Before you begin

## What's in the box

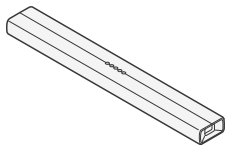

Sound bar

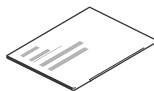

Quick start guide



Safety instructions

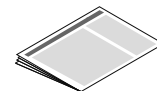

Cautions on using batteries



Wall mount template

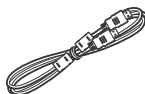

HDMI cable (4K)

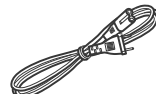

Power cord  
(European model only)

or



Power cord  
(Australian model only)



Optical digital cable



Wall mount spacers



Remote control  
(RC-1251)



2x R03/AAA batteries

# 1 Place the sound bar

For the best listening experience, place the sound bar centered under your TV and flush with the front edge of your cabinet.

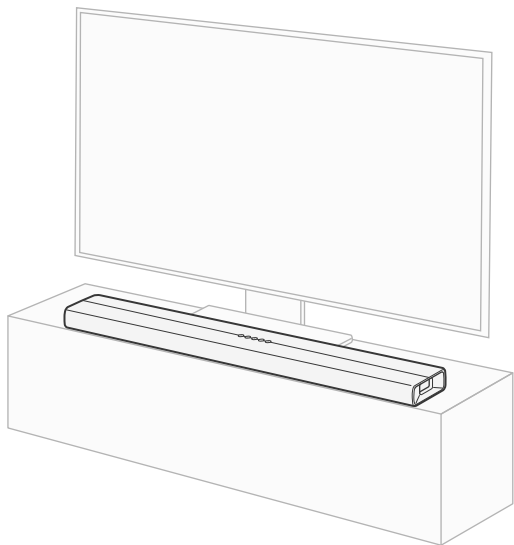

- The sound bar can also be mounted on a wall. Refer to the included wall mount template for details.
- For additional wall mounting assistance, refer to the online owner's manual or consult with your local Denon dealer or professional installer.

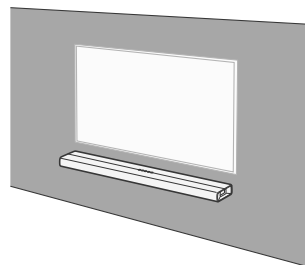

**Owner's manual**

[manuals.denon.com/DHTS217/EU/EN/](https://manuals.denon.com/DHTS217/EU/EN/)



## 2

# Connect the sound bar to your TV

1. Connect one end of the HDMI cable to the port labeled “eARC” or “ARC” on your TV.
2. Connect the other end of the HDMI cable to the port marked “TV (HDMI eARC/ARC)” on your sound bar.

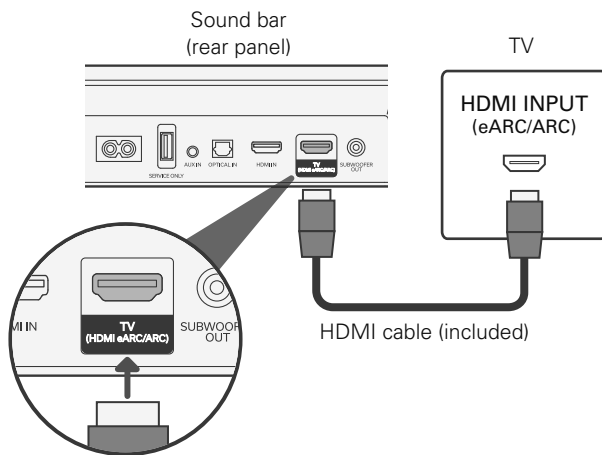

- If the TV does not have an HDMI labeled “eARC” or “ARC”, connect the sound bar to the TV using the optical cable. Please note that an optical connection does not support Dolby Atmos.

### 3 Connect the power cord to a wall outlet

Connect the included power cord to the sound bar, and insert the plug into an outlet.

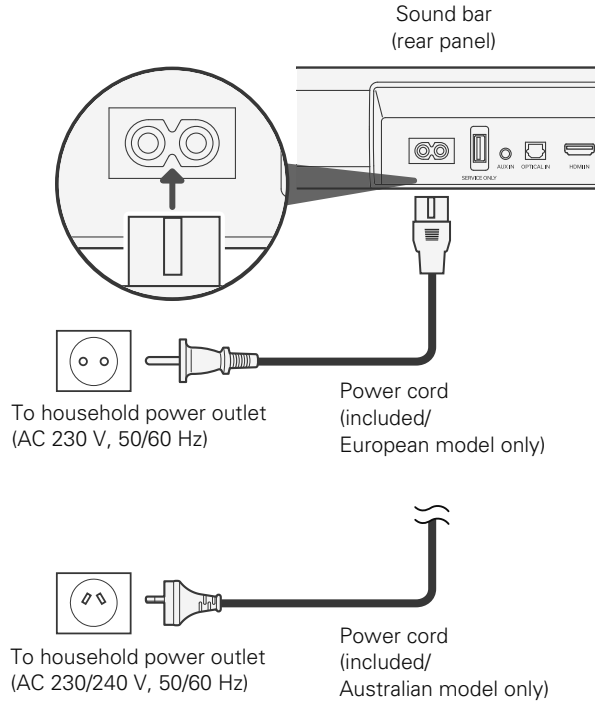

### 4 Install batteries in the remote control

Slide off the cover on the back of the remote control and insert the batteries in the proper orientation.

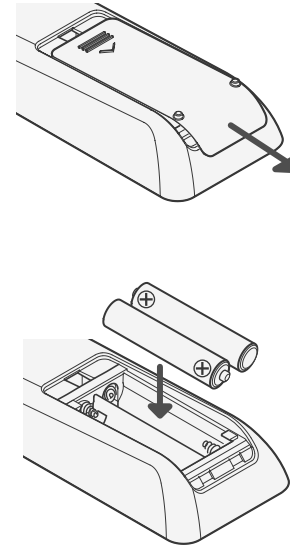

## 5 Setup is now complete!

Turn on your TV and verify that you hear sound playing from the sound bar.



- If you hear an echo or audio coming from the TV's internal speakers, make sure the TV speakers are switched off in the TV settings menu. Refer to the TV user manual for guidance.

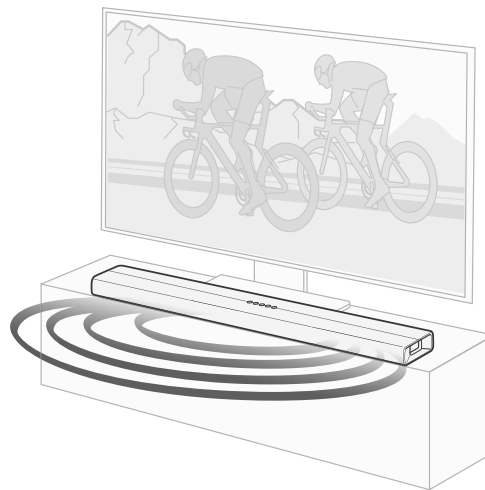

### Owner's manual

- Refer to the online manual for other functions, information and operation procedure details.  
**[manuals.denon.com/DHTS217/EU/EN/](https://manuals.denon.com/DHTS217/EU/EN/)**
- For more information, visit **[www.denon.com](https://www.denon.com)**



# About the status lights

The sound bar lights indicate the power state, input source, audio format and other status information.



Power	Off (Standby)	<input type="radio"/>	<input type="radio"/>	<input type="radio"/>	<input type="radio"/>	<input type="radio"/>
	On	<input checked="" type="radio"/>	<input type="radio"/>	<input type="radio"/>	<input type="radio"/>	<input type="radio"/>
Input source	TV (HDMI eARC/ARC)	<input checked="" type="radio"/>	<input type="radio"/>	<input type="radio"/>	<input type="radio"/>	<input type="radio"/>
	HDMI	<input type="radio"/>	<input type="radio"/>	<input type="radio"/>	<input type="radio"/>	<input type="radio"/>
	TV (OPTICAL)	<input type="radio"/>	<input type="radio"/>	<input checked="" type="radio"/>	<input type="radio"/>	<input type="radio"/>
	AUX	<input type="radio"/>	<input type="radio"/>	<input type="radio"/>	<input checked="" type="radio"/>	<input type="radio"/>
	Bluetooth®	<input type="radio"/>	<input type="radio"/>	<input type="radio"/>	<input checked="" type="radio"/>	<input type="radio"/>
Audio format	Dolby Atmos®	<input checked="" type="radio"/>	<input type="radio"/>	<input type="radio"/>	<input type="radio"/>	<input type="radio"/>
	Dolby® (other than Atmos)	<input checked="" type="radio"/>	<input type="radio"/>	<input type="radio"/>	<input type="radio"/>	<input type="radio"/>
	PCM (or No Signal)	<input type="radio"/>	<input type="radio"/>	<input type="radio"/>	<input type="radio"/>	<input type="radio"/>
	Unsupported audio format	<input checked="" type="radio"/>	<input type="radio"/>	<input type="radio"/>	<input type="radio"/>	<input type="radio"/>

# Streaming music via Bluetooth

- ① Press the  (Bluetooth) button on the sound bar (or remote control) to switch the input source to “Bluetooth”.

When you use it for the first time, the sound bar automatically enters pairing mode and the Bluetooth light blinks blue.

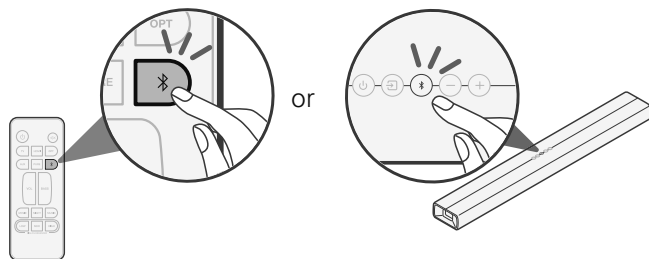

- ② Go to the Bluetooth settings on your device, and make sure Bluetooth is turned ON.

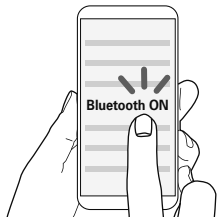



- ③ Select “Denon DHT-S217”.

The Bluetooth light on the sound bar turns solid blue when pairing is complete.

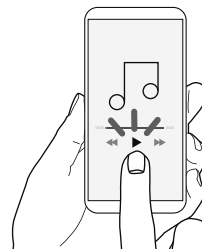

- ④ Play music using any app on your Bluetooth device.



- To pair with other Bluetooth devices, press and hold the  button until the Bluetooth light blinks blue. The sound bar enters pairing mode.



# Trademark information



COMPATIBLE WITH



Dolby, Dolby Vision, Dolby Atmos, and the double-D symbol are registered trademarks of Dolby Laboratories Licensing Corporation. Manufactured under license from Dolby Laboratories. Confidential unpublished works. Copyright © 2012–2021 Dolby Laboratories. All rights reserved.



The terms HDMI and HDMI High-Definition Multimedia Interface, and the HDMI Logo are trademarks or registered trademarks of HDMI Licensing, LLC in the United States and other countries.



The Bluetooth® word mark and logos are registered trademarks owned by the Bluetooth SIG, Inc. and any use of such marks by D&M Holdings Inc. is under license. Other trademarks and trade names are those of their respective owners.

**DENON®**

[www.denon.com](http://www.denon.com)

Printed in China 5411 11981 00AD  
© 2022 Sound United. All Rights Reserved.