

DENON DNP-720AE Network setup guide

Connecting the DNP-720AE to the network

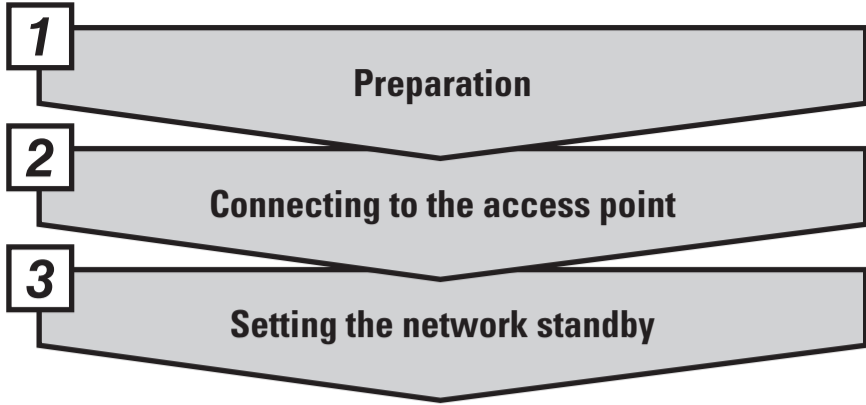

1 Complete Steps ① - ③.

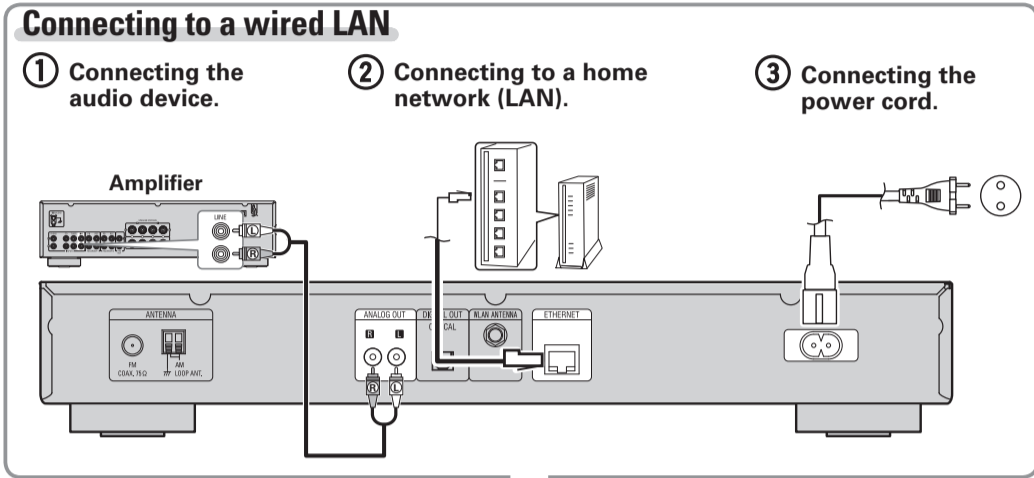

Basic operation

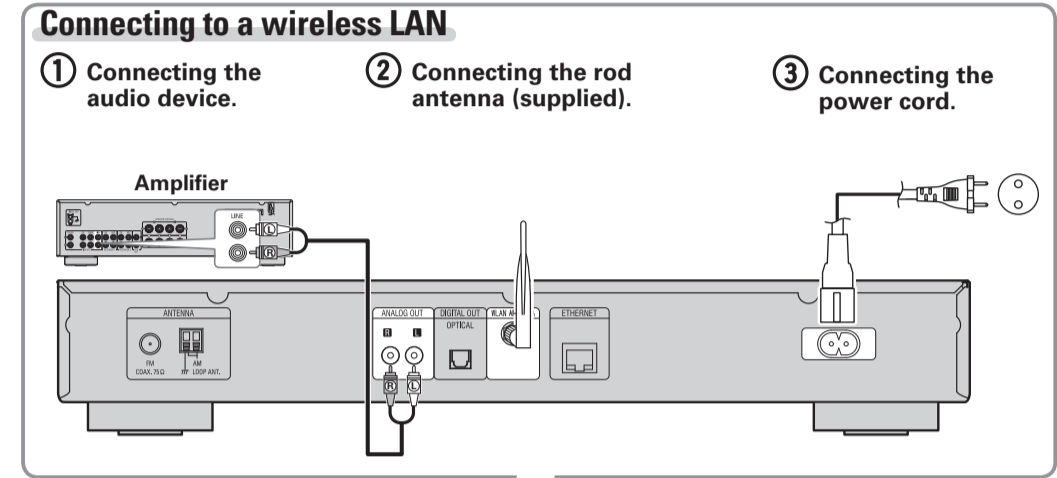
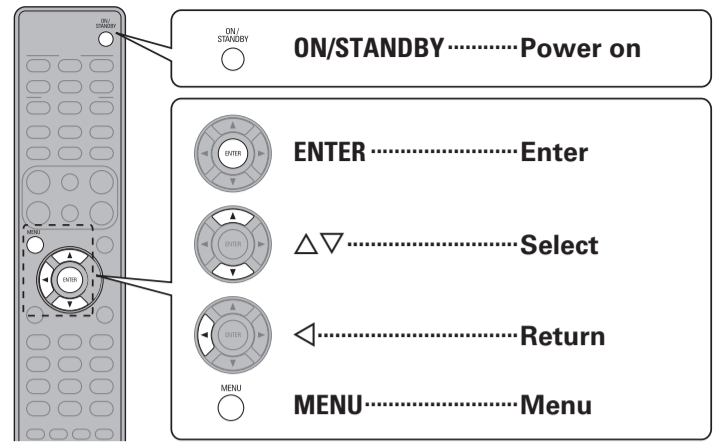

2

- Press ON/STANDBY to turn the power on.
- Select the menu language.
- Check the connection to the network device, and press ENTER.
- Select "Wired", and press ENTER.
- Select "Connection", and press ENTER.

• Connected to the network.

❑ WPS function not compatible access point (Most users)

- Press ON/STANDBY to turn the power on.
- Select the menu language.
- Check the connection to the network device, and press ENTER.
- Select "Wireless", and press ENTER.
- Select "Search Access Point", and press ENTER.

- Select the access point to connect to, and press ENTER.
- Select "Key", and press ENTER.
- Input the security key, and press ENTER.
 - The types of characters that can be input are as shown below.
 - [Lower case characters] abcdefghijklmnopqrstuvwxyz
 - [Upper case characters] ABCDEFGHIJKLMNOPQRSTUVWXYZ
 - [Symbols] ! " # \$ % & ' () * + , - . / : ; < = > ? @
 - [Numbers] 0 1 2 3 4 5 6 7 8 9 (Space)

• Connected to the network.

❑ WPS function compatible access point

- Press ON/STANDBY to turn the power on.
- Select the menu language.
- Check the connection to the network device, and press ENTER.
- Select "Wireless", and press ENTER.
- Select "WPS", and press ENTER.
- Select "Push Button", and press ENTER.
- Press the WPS button on the access point.
- Select "Enter", and press ENTER.

• Connected to the network.

3

❑ Enabling the network standby

Select "On", and press ENTER.
Reduces the amount of time until the network connection is complete.

NOTE
The amount of power consumption during standby mode increases slightly.

❑ Disabling the network standby

Select "Off", and press ENTER.
The amount of power consumption during standby mode is as low as possible.

This completes the network connections and settings. The network settings can also be configured in the "Network" - "Connection" menu. See the Owner's Manual for details on setting using the "Connection" menu.

To perform "Network First Setup" again

- Press MENU.
The menu screen is displayed.
- Select "Network", and press ENTER.

- Select "Network First Setup", and press ENTER.